

ASSEMBLY & INSTALLATION INSTRUCTIONS

B565

202117 Zen Sconce

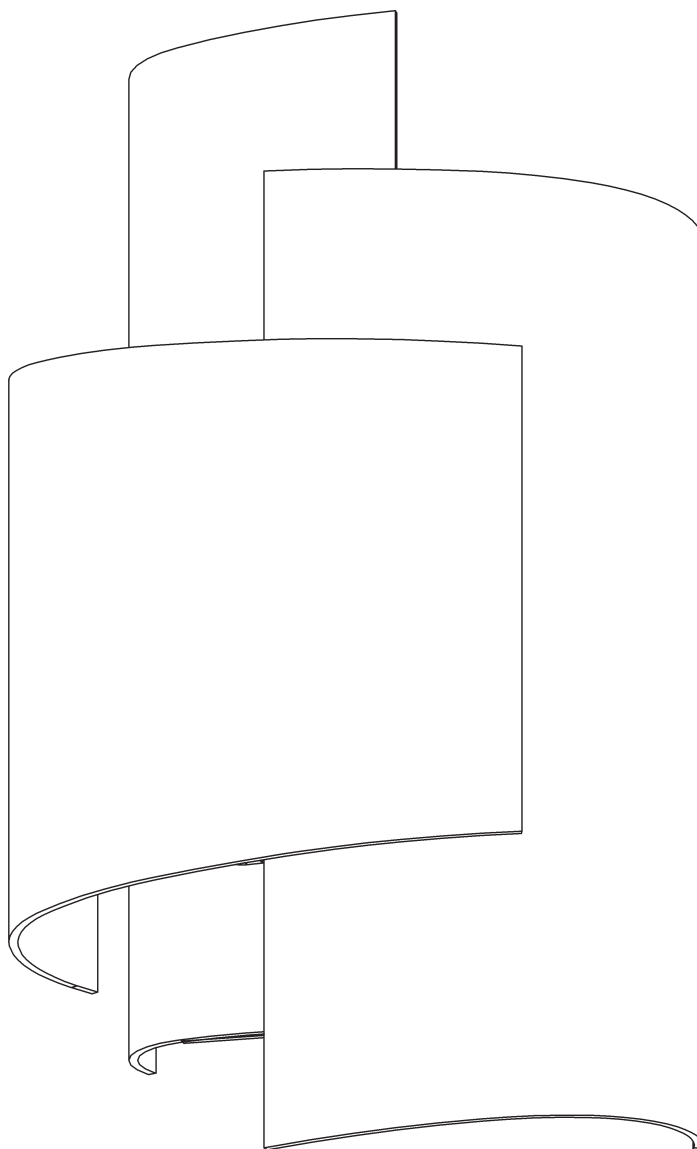

HUBBARDTON FORGE.

MODERN AMERICAN BLACKSMITHS | FINE, HAND CRAFTED LIGHTING
CASTLETON, VERMONT USA | HUBBARDTONFORGE.COM

58265

1 OF 4

Component Parts

- A Fixture
- B Mounting Bracket
- C Anchors (6)
- D #10 Screws (6)
- E Ground Screw
- F Cupped Washer
- G #8 Screws (4)
- H Socket
- I Bulb

ASSEMBLY & INSTALLATION INSTRUCTIONS

B565

202117 Zen Sconce

CAUTION: FAILURE TO INSTALL THIS FIXTURE PROPERLY MAY RESULT IN SERIOUS PERSONAL INJURY OR DEATH AND PROPERTY DAMAGE. We recommend installation by a licensed electrician. This product must be installed in accordance with applicable installation code(s), by a person familiar with the construction and operation of the product and the hazards involved.*

Caution: Do not exceed maximum wattage noted on fixture. Use only recommended bulbs with fixture.

To Install Fixture (Figures 1 & 2 - on next page)

1. Carefully unpack the fixture (A) from the carton.
2. Remove (4) #8 screws (G) holding mounting bracket (B) to fixture (A). Retain screws (G) for later step. Remove mounting bracket (B) from fixture (A).
3. Place mounting bracket (B) over the electrical box being sure to hold it level. Line up holes in mounting bracket with holes in electrical box. With a pencil, mark locations of mounting holes in mounting bracket on wall behind. Set bracket aside.
4. Drill 1/4" holes in the locations marked on the wall. Place the tapered end of the anchors (C) into the holes and gently tap them flush to the wall using a light weight hammer.
5. Thread wires in electrical box through hole in mounting bracket (B) while moving bracket into position. Using (2) machine screws (not provided), attach the bracket securely to the junction box.
Note: A new electric box comes with screws. When replacing an existing fixture, retain screws for use with the new fixture
6. Using #10 screws (D), screw bracket securely to wall. Be careful not to over-tighten or strip anchors (C).
7. Attach a pigtail lead to mounting bracket (B) using ground screw (E) and cupped washer (F) found in kit bag.
8. Hold fixture (A) close to wall. Using suitable wire connectors (not provided), connect fixture wires to supply wires (white to white and black to black). Connect all ground wires (bare copper or green to bare copper or green) together.

CAUTION: MAKE SURE WIRE CONNECTORS ARE TWISTED ON SECURELY, AND NO BARE WIRE IS EXPOSED.

9. Place fixture (A) over mounting bracket (B). Secure with #8 screw (G) on top and in bottom of fixture.

CAUTION: BE SURE NO WIRES ARE PINCHED BETWEEN THE WALL AND FIXTURE.

10. Screw bulb (I), not included, into socket (H).
11. Restore electricity at main breaker.

ASSEMBLY & INSTALLATION INSTRUCTIONS

B565

202117 Zen Sconce

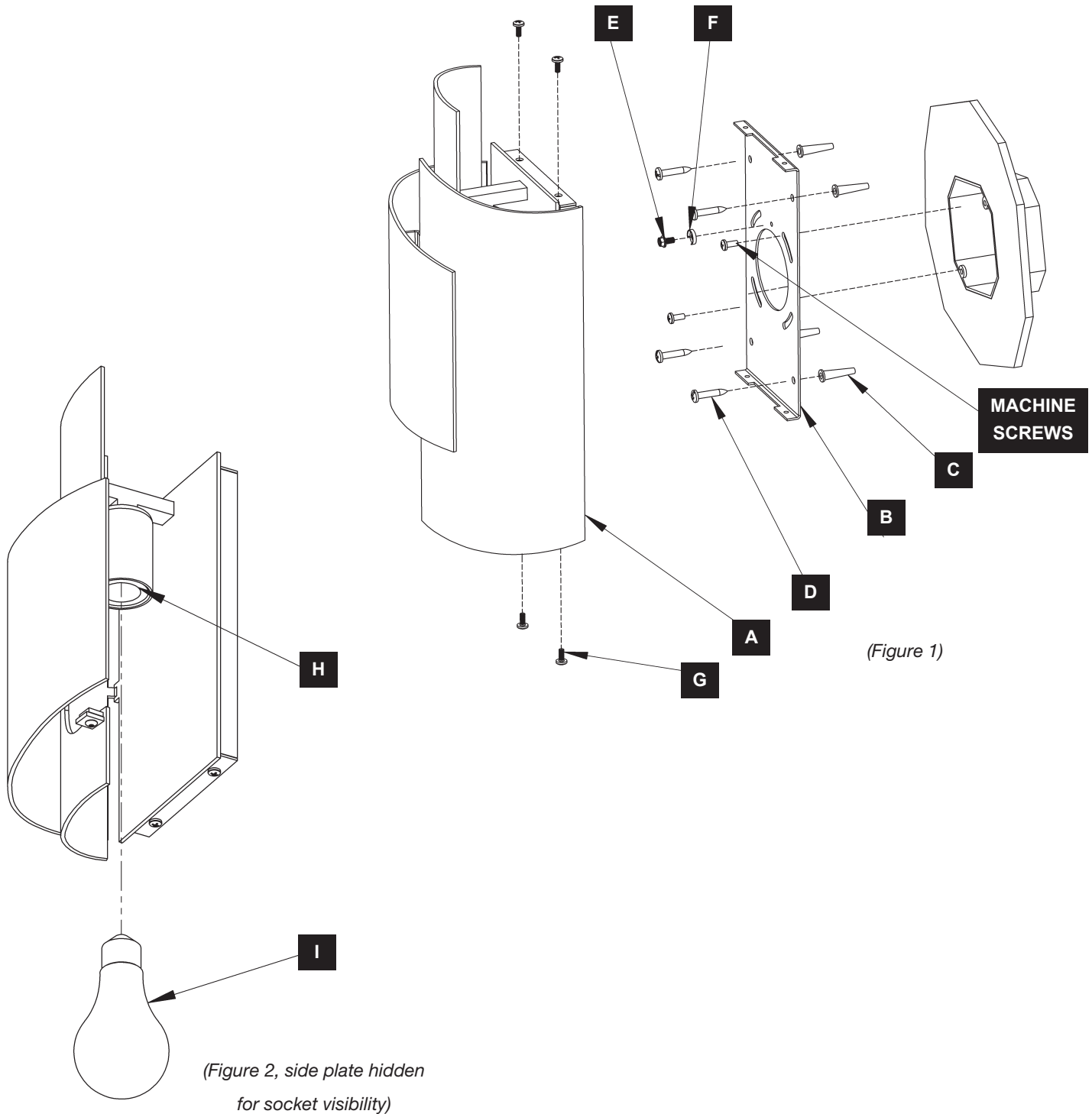

If you need further assistance, or find that you are missing any parts, please contact the dealer from which you purchased this product. We hope you enjoy your fixture!

*** Hubbardton Forge will not be liable for injury or damage caused by improper installation, lamping or use of this fixture.**



HUBBARDTON FORGE.

MODERN AMERICAN BLACKSMITHS | FINE, HAND CRAFTED LIGHTING
CASTLETON, VERMONT USA | HUBBARDTONFORGE.COM

58265

4 OF 4