

ASSEMBLY & INSTALLATION INSTRUCTIONS

Parasol Sconce 201309

B549



Component Parts

- A Fixture**
- B Mounting Bracket**
- C Ground Screw**
- D Cupped Washer**
- E #8 Screws (4)**
- F Socket**
- G Bulb (Not Included)**
- H Glass**
- I Socket Cup**

CAUTION: FAILURE TO INSTALL THIS FIXTURE PROPERLY MAY RESULT IN SERIOUS PERSONAL INJURY OR DEATH AND PROPERTY DAMAGE. We recommend installation by a licensed electrician. This product must be installed in accordance with applicable installation code(s), by a person familiar with the construction and operation of the product and the hazards involved.*

Caution: Do not exceed maximum wattage noted on fixture. Use only recommended bulbs with fixture.

Please Note: After installation extra hardware and accessories are possible; our kits are used on multiple products.

To Install Fixture (Figure 1)

CAUTION: BE SURE POWER IS OFF AT THE MAIN BREAKER BOX PRIOR TO INSTALLATION.

1. Carefully unpack the fixture (A) from the carton.
2. Using two machine screws (not provided) attach mounting bracket (B) to the electric box ensuring correct orientation. (refer to Figure 1 for correct orientation - **Angled cut out must be on bottom**)

Note: A new electric box comes with screws. When replacing a fixture, retain the screws for use with the new fixture.

3. Attach a pigtail lead to the mounting bracket (B) using the ground screw (C) and cupped washer (D).
4. Hold fixture (A) close to wall. Using suitable wire connectors (not provided), connect fixture wires to supply wires (white to white and black to black). Connect all ground wires (bare copper or green to bare copper or green).

CAUTION: MAKE SURE WIRE CONNECTORS ARE TWISTED ON SECURELY, AND NO BARE WIRE IS EXPOSED.

5. Place fixture (A) over mounting bracket (B). Cross plate in back of fixture (A) will hook onto top of mounting bracket (B). Secure with #8 screw (E) in bottom of fixture.

Note: It may be necessary to loosen #8 screw (E) to allow fixture to sit against wall before re-tightening against mounting bracket (B).

CAUTION: BE SURE NO WIRES ARE PINCHED BETWEEN WALL AND FIXTURE.

6. Follow steps on remaining pages to install glass.

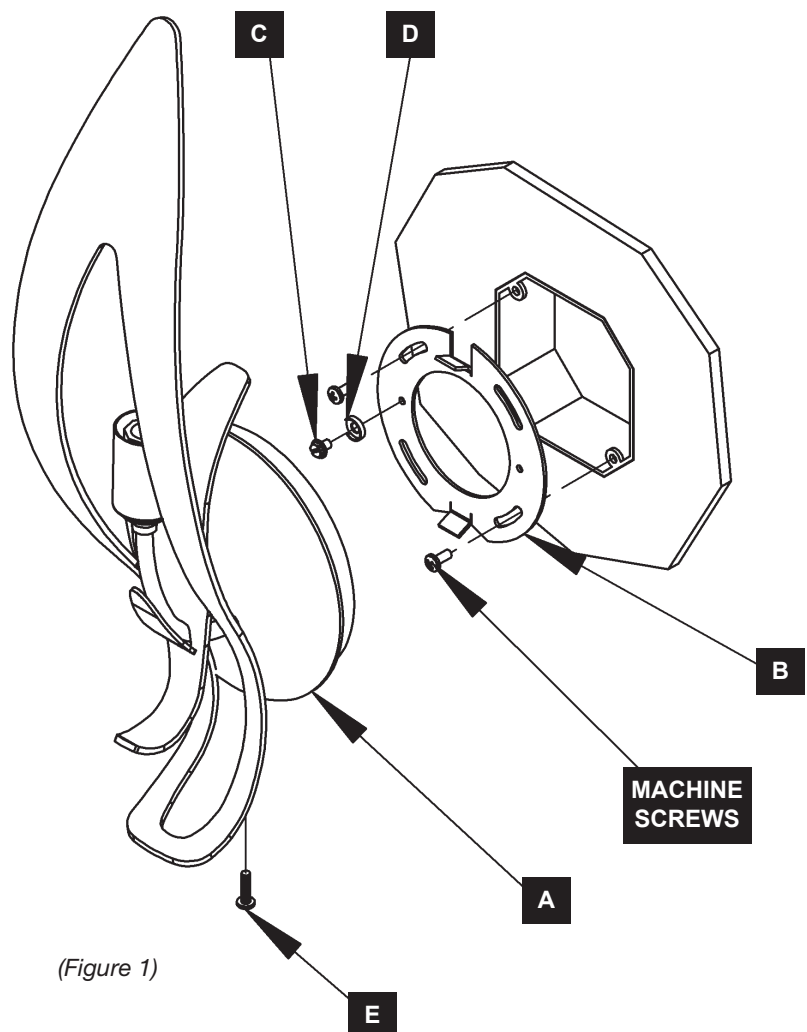

(Figure 1)

Parasol Sconce 201309

To Install Glass (Figure 2)

1. Carefully unpack glass (H).
2. Install bulb (G), not included, into socket (F).
3. Slip glass (H) around bulb (G) and allow to rest in arm of fixture (A).
4. End of glass (H) should be hidden behind front tab.
5. Restore electricity at main breaker.

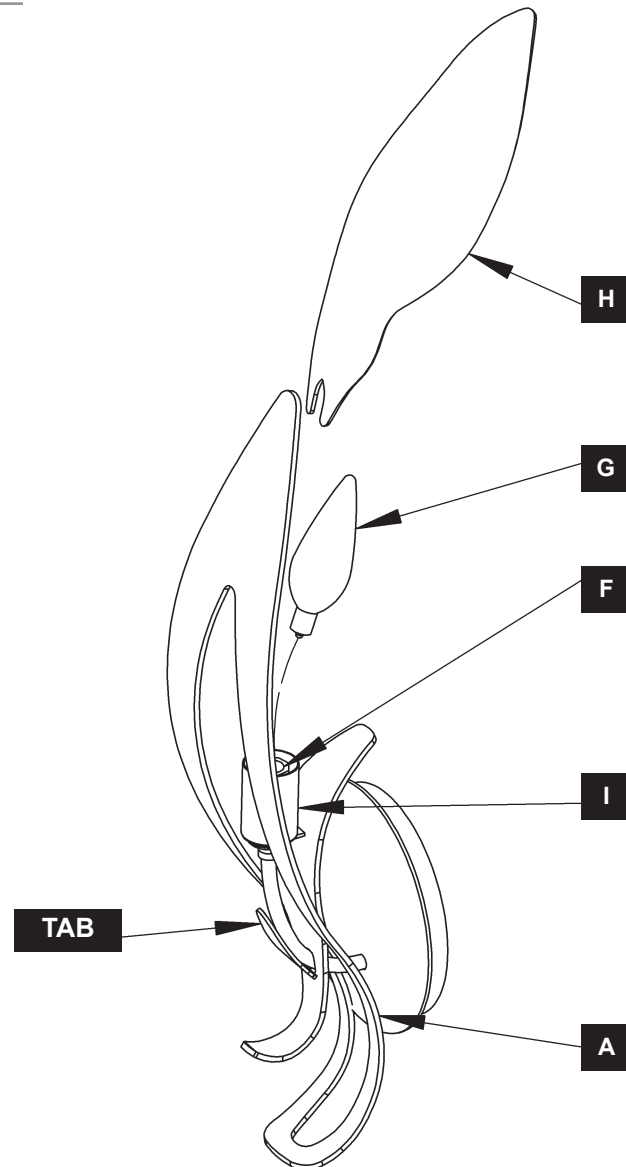

(Figure 2)

If you need further assistance, or find that you are missing any parts, please contact the dealer from which you purchased this product. We hope you enjoy your fixture!

*** Hubbardton Forge will not be liable for injury or damage caused by improper installation, lamping or use of this fixture.**



HUBBARDTON FORGE.