

# ASSEMBLY & INSTALLATION INSTRUCTIONS

A190

Ribbon Chandeliers 104113, 104115, 104116 & 104117

---

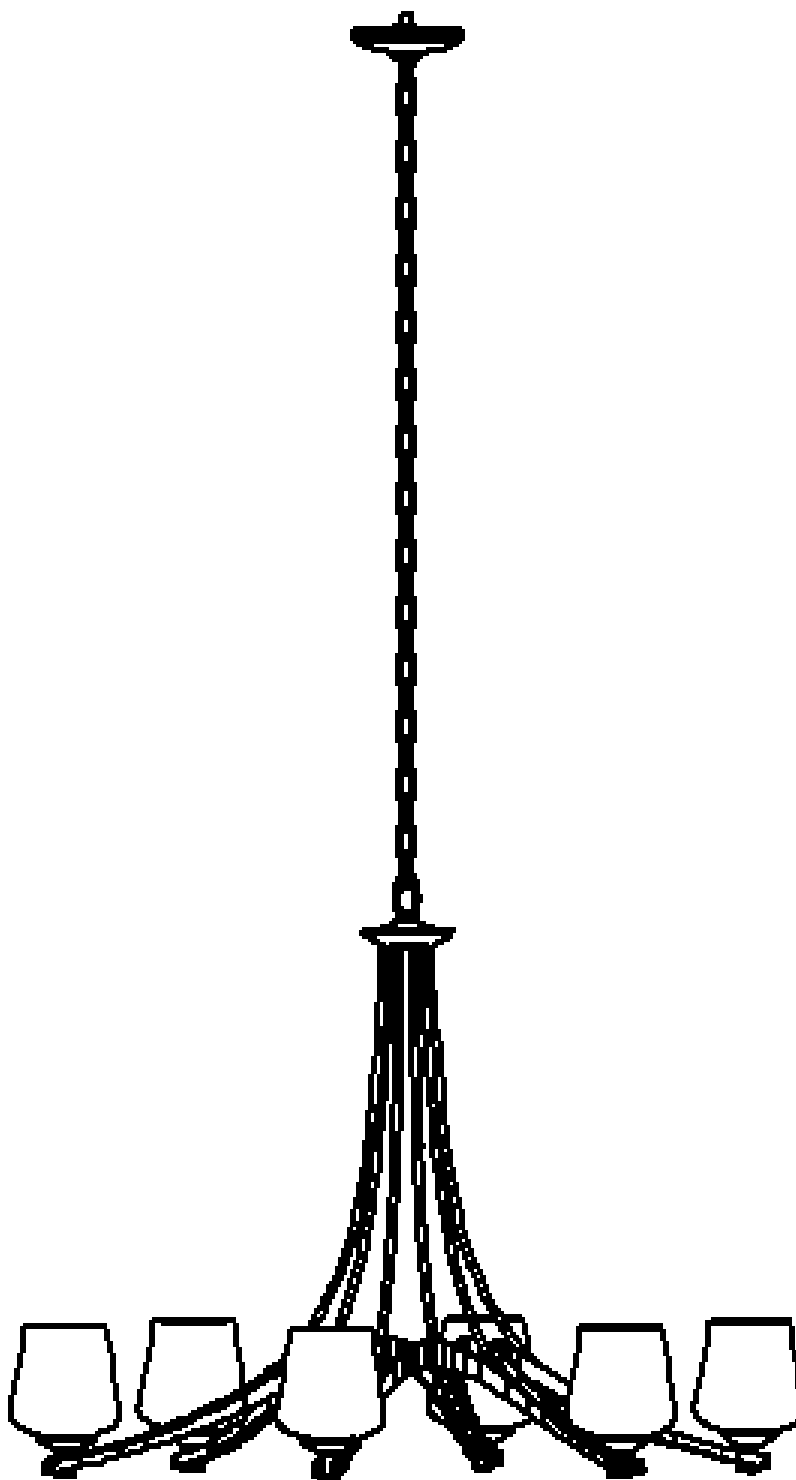

HUBBARDTON FORGE.

MODERN AMERICAN BLACKSMITHS | FINE, HAND CRAFTED LIGHTING  
CASTLETON, VERMONT USA | HUBBARDTONFORGE.COM

22362 Rev A

## Component Parts

- A Ground screw**
- B Crossbar**
- C Lock Nut**
- D Nipple**
- E Canopy**
- F Canopy Loop**
- G Loop Collar**
- H Fixture Loop**
- I Socket (6)**
- J Bulb (not included)**
- K Retaining Ring (12)**
- L Inner Glass (6)**
- M Outer Glass (6)**
- N Socket Tool**
- O Spacer (6)**



# ASSEMBLY & INSTALLATION INSTRUCTIONS

A190

Ribbon Chandeliers 104113, 104115, 104116 & 104117

**CAUTION: FAILURE TO INSTALL THIS FIXTURE PROPERLY MAY RESULT IN SERIOUS PERSONAL INJURY OR DEATH AND PROPERTY DAMAGE.** We recommend installation by a licensed electrician. This product must be installed in accordance with applicable installation code(s), by a person familiar with the construction and operation of the product and the hazards involved.\*

Caution: Do not exceed maximum wattage noted on fixture. Use only recommended bulbs with fixture.

Please Note: After installation extra hardware and accessories are possible due to our kits are used on multiple products and options.

## To Install the Canopy (Figure 1)

**CAUTION: BE SURE POWER IS OFF AT THE MAIN BREAKER BOX PRIOR TO INSTALLATION.**

1. Carefully unpack fixture from the carton.
2. Using two machine screws (not provided), fasten the crossbar (B) to the electric box (see illustration).

**Note:** A new electric box comes with screws. When replacing a fixture, retain the existing screws for use with the new fixture.

3. Thread the nipple (D) into the crossbar (B) and secure with lock nut (C); slide canopy (E) over nipple (D), and attach the canopy loop (F) to the nipple (D). Adjust the nipple to proper length to ensure a snug canopy fit before proceeding.
4. Attach one end of the chain to the fixture loop (H). Lace the wire through every other link of the chain to the end. Slip wires and chain through the collars and canopy (G, F & E). Fasten the chain to the canopy loop (F), and then slip wires through the loop and nipple, into the electric box. Make sure to provide enough slack in the wire to ensure weight of fixture is supported by the chain.
5. Using suitable wire connectors (not provided) connect fixture wires to supply wires (white to ribbed side of the fixture s cord, black to smooth side). Run a pigtail lead from crossbar ground screw (A) to the junction box and connect all ground wires (bare copper or green to bare copper or green).

**CAUTION: MAKE SURE WIRE CONNECTORS ARE TWISTED ON SECURELY AND NO BARE WIRE IS EXPOSED.**

6. Raise canopy (E) to the ceiling and secure loop collar (G) to canopy loop (F).

# ASSEMBLY & INSTALLATION INSTRUCTIONS

A190

Ribbon Chandeliers 104113, 104115, 104116 & 104117

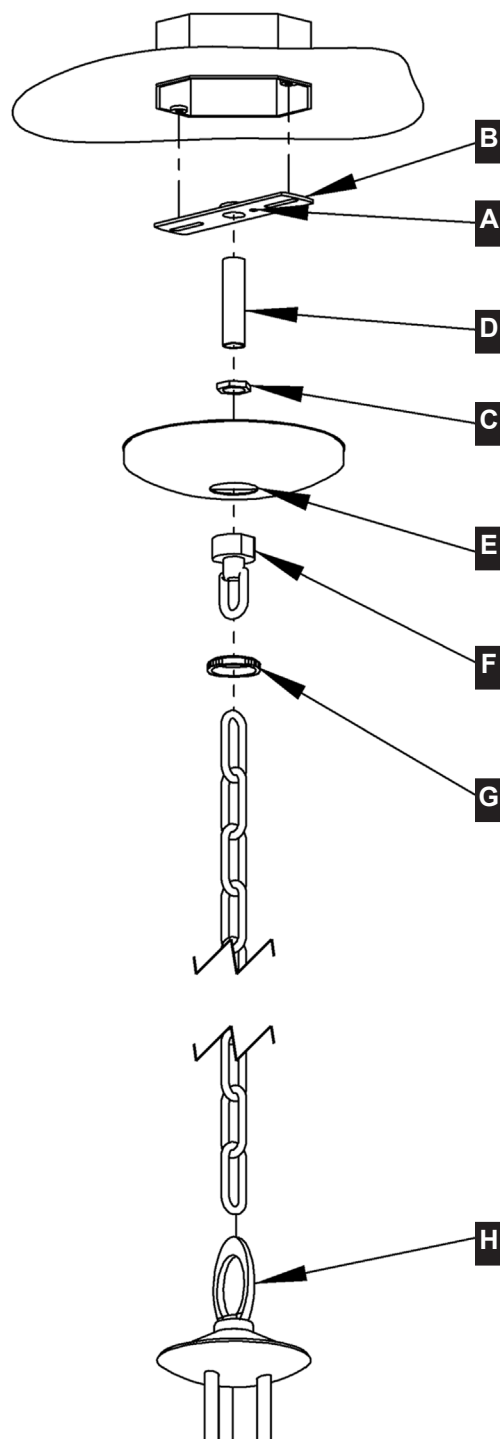

(Figure 1)



HUBBARDTON FORGE.

MODERN AMERICAN BLACKSMITHS | FINE, HAND CRAFTED LIGHTING  
CASTLETON, VERMONT USA | HUBBARDTONFORGE.COM

22362 Rev A

# ASSEMBLY & INSTALLATION INSTRUCTIONS

A190

Ribbon Chandeliers 104113, 104115, 104116 & 104117

## To Install Glass (Figure 2)

1. Remove two retaining rings (K) from socket (I). *Retaining rings are shipped installed on socket.*
2. Install light bulb (J), (not included). Be careful not to touch bulb with bare hands; oil from the hands will dramatically reduce bulb life.
3. Slip outer glass (M) and spacer (O) over socket (I) and thread one of the retaining rings (K) onto the socket (I) using provided socket tool (N). *Note: Flat side of retaining ring should be oriented as shown.*
4. Slip inner glass (L) over socket (I).
5. Thread retaining ring (K) onto socket (I) using provided socket tool (N) until snug against inner glass (L). Be careful not to over tighten. *Note: Flat side of retaining ring should be oriented as shown.*
6. Restore electricity at the main breaker.

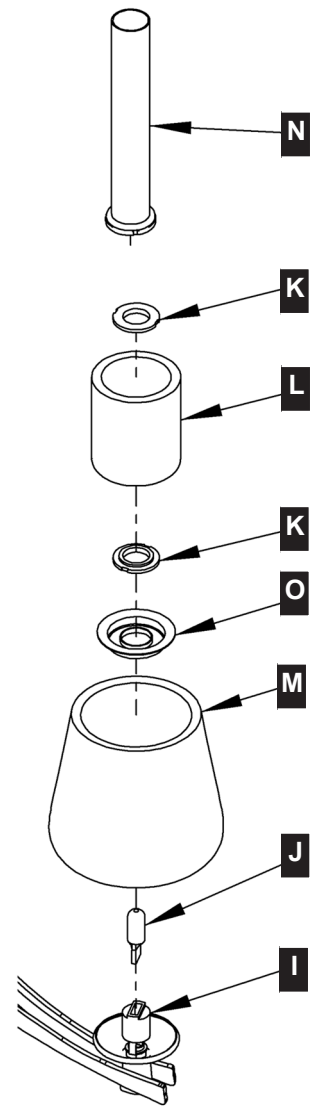

(Figure 2)

If you need further assistance, or find that you are missing any parts, please contact the dealer from which you purchased this product. We hope you enjoy your fixture!

**\* Hubbardton Forge will not be liable for injury or damage caused by improper installation, lamping or use of this fixture.**