

ASSEMBLY & INSTALLATION INSTRUCTIONS

A997

Lilium 12lt Chandelier 101706

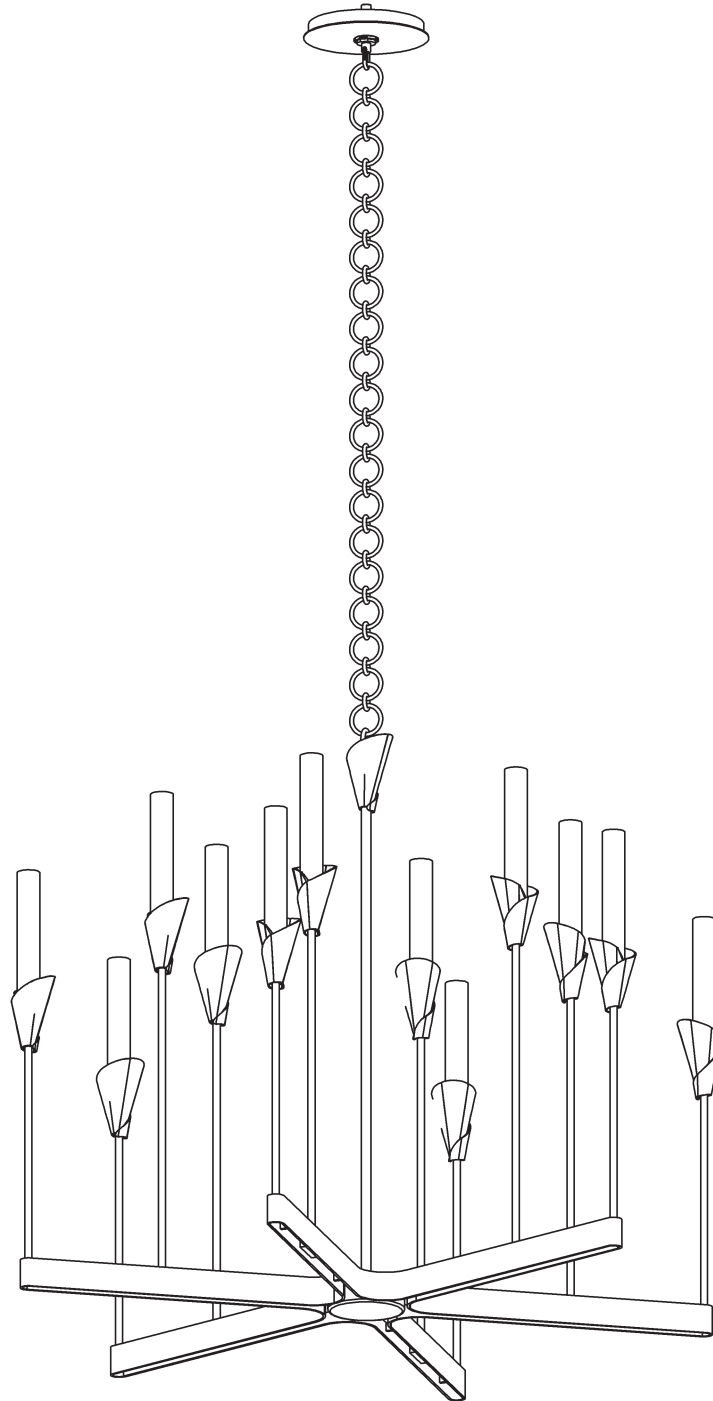

HUBBARDTON FORGE.

MODERN AMERICAN BLACKSMITHS | FINE, HAND CRAFTED LIGHTING
CASTLETON, VERMONT USA | HUBBARDTONFORGE.COM

55948

1 OF 4

Component Parts

- A Fixture**
- B Crossbar**
- C Ground Screw**
- D Lock Nut**
- E Nipple**
- F Canopy**
- G Canopy Ring**
- H Canopy Loop**
- I Fixture Loop**
- J Chain**
- K Socket (12)**
- L Bulb (12) - not included**
- M Glass (12)**
- N Center Pipe Assembly**
- O Spring Loop**
- P Fixture Coupling**



ASSEMBLY & INSTALLATION INSTRUCTIONS

A997

Lilium 12lt Chandelier 101706

CAUTION: FAILURE TO INSTALL THIS FIXTURE PROPERLY MAY RESULT IN SERIOUS PERSONAL INJURY OR DEATH AND PROPERTY DAMAGE. We recommend installation by a licensed electrician. This product must be installed in accordance with applicable installation code(s), by a person familiar with the construction and operation of the product and the hazards involved.*

Caution: Do not exceed maximum wattage noted on fixture. Use only recommended bulbs with fixture.

Please Note: After installation extra hardware and accessories are possible due to our kits are used on multiple products and options.

To Install the Canopy (Figures 1 & 2 - on following page)

CAUTION: BE SURE POWER IS OFF AT THE MAIN BREAKER BOX PRIOR TO INSTALLATION.

1. Carefully unpack fixture (A) from the carton.
2. Locate center pipe assembly (N). Run wires exiting fixture coupling (P) through center pipe assembly (N).
3. Apply loctite to threads of fixture coupling (P).

NOTE: APPLICATION OF THE THREAD LOCKING COMPOUND IS NECESSARY TO PREVENT THE PIPE FROM LOOSENING DURING REGULAR MAINTENANCE AND CLEANING OF THE FIXTURE. BE CERTAIN TO APPLY THE COMPOUND.

4. Thread center pipe assembly (N) into fixture coupling (P) and tighten.
5. Using two machine screws (not provided), temporarily fasten the crossbar (B) to the electric box with ground screw (C) facing down.
Note: A new electric box comes with screws. When replacing a fixture, retain the existing screws for use with the new fixture.
6. Thread nipple (E) into crossbar (B) and then thread lock nut (D) and canopy loop (H) onto threaded nipple, leaving parts loose. Adjust length of threaded nipple in crossbar so that canopy ring (G), which comes threaded onto canopy loop (H), will hold canopy (F) against the ceiling with no threads showing for best appearance. When correct adjustment is established, tighten lock nut (D) against crossbar (B) to hold adjustment.
7. Remove the crossbar (B) assembly from electrical box.
8. One end of chain (J) is attached to fixture loop (I). Lace the wire through every other link of the chain (J) to the end. Slip wires through canopy ring (G), canopy loop (H) and canopy (F). Fasten the chain (J) to the canopy loop (H) using provided spring loop (O).
9. Reattach crossbar (B) to electrical box.
10. Slip wires through the nipple (E) and into the electrical box. Make sure to provide enough slack in the wire to ensure weight of fixture is supported by the chain (J).
11. Using suitable wire connectors (not provided) connect fixture wires to supply wires (white to ribbed side of the fixture cord, black to smooth side). Run a pigtail lead from crossbar ground screw (C) to the electrical box and connect all ground wires (bare copper or green to bare copper or green).

CAUTION: MAKE SURE WIRE CONNECTORS ARE TWISTED ON SECURELY AND NO BARE WIRE IS EXPOSED.

12. Raise canopy (F) to the ceiling and secure canopy ring (G) to canopy loop (H).
13. Follow instructions on next page to install glass.

ASSEMBLY & INSTALLATION INSTRUCTIONS

Lilium 12lt Chandelier 101706

A997

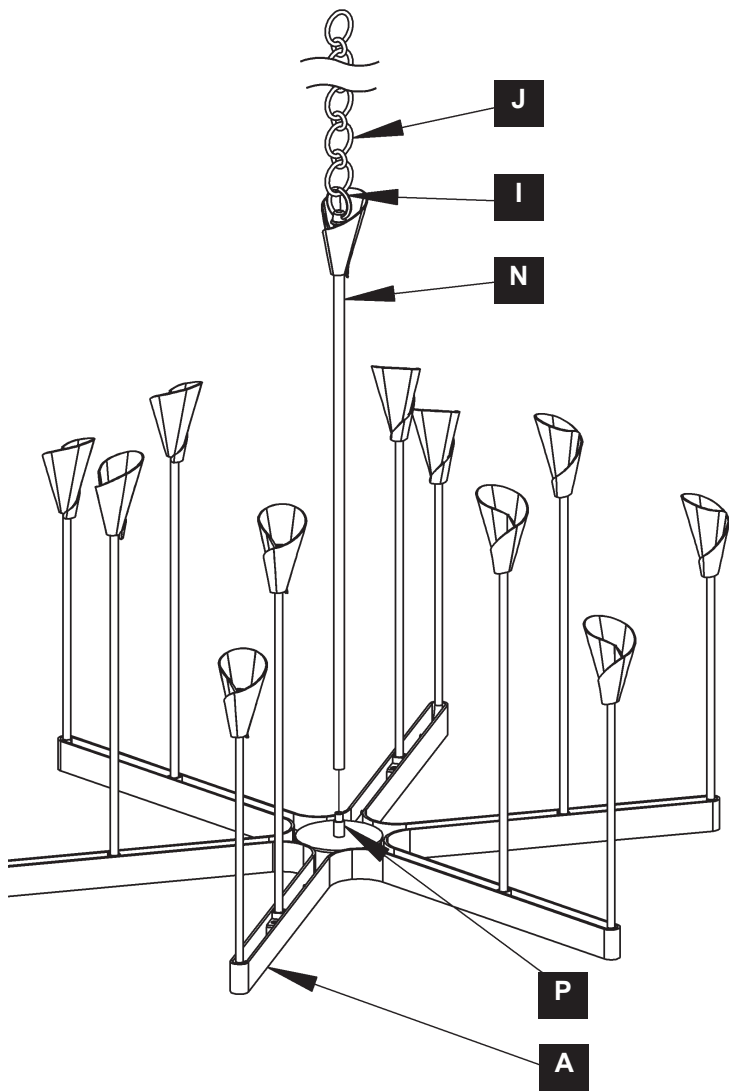

(Figure 1)

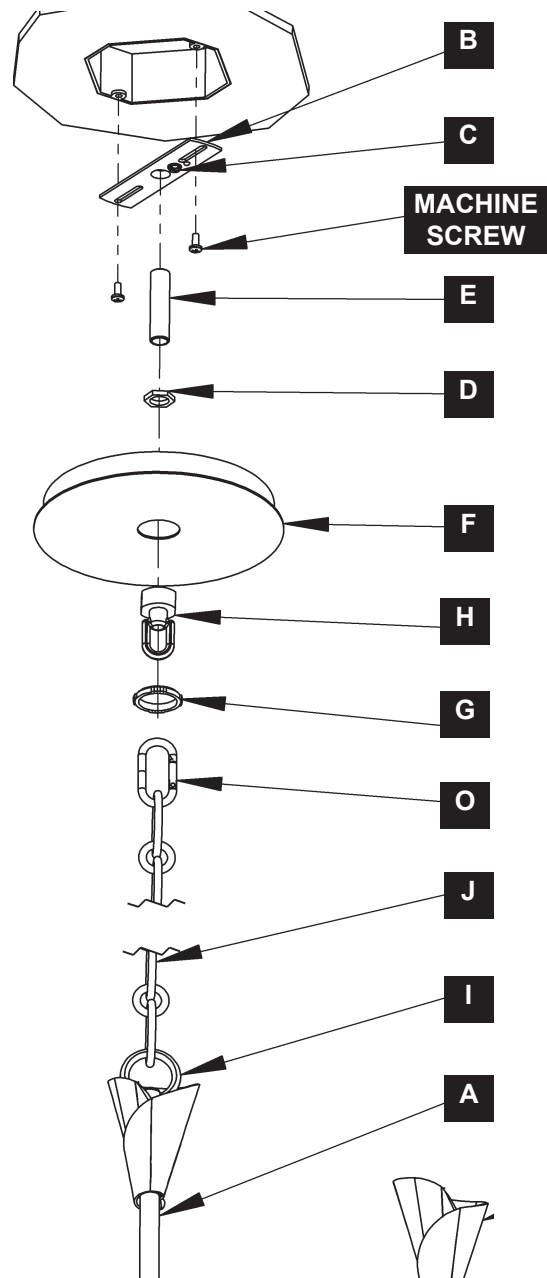

(Figure 2)



HUBBARDTON FORGE.

MODERN AMERICAN BLACKSMITHS | FINE, HAND CRAFTED LIGHTING
CASTLETON, VERMONT USA | HUBBARDTONFORGE.COM

55948

4 OF 4

Lilium 12lt Chandelier 101706

To Install Glass (Figure 3)

1. Carefully unpack glass (M).
2. Install bulb (L), not included, into socket (K) .
3. Place glass (M) over bulb (L) and thread glass (M) onto socket (K).

Caution: Be careful not to overtighten as this could break glass.

4. Repeat for remaining bulbs (L) and glass (M).
5. Restore electricity at main breaker.

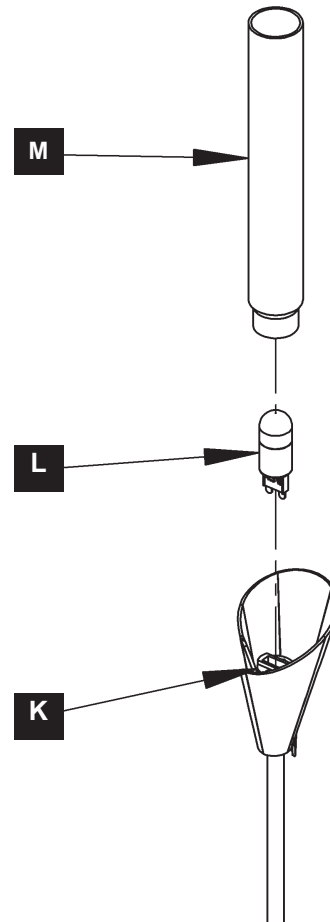

(Figure 3)

If you need further assistance, or find that you are missing any parts, please contact the dealer from which you purchased this product. We hope you enjoy your fixture!

*** Hubbardton Forge will not be liable for injury or damage caused by improper installation, lamping or use of this fixture.**